

ONE 9 FIVE

ASOKE - RAMA 9



ONE 9 FIVE

ASOKE-RAMA 9

AWARD WINNER 2022

DOT PROPERTY AWARDS
SOUTHEAST ASIA 2022

BEST HIGH END CONDOMINIUM DEVELOPMENT



PROPERTYGURU THAILAND
PROPERTY AWARDS 2022

BEST HIGH END HIGH RISE
CONDO DEVELOPMENT (BANGKOK)

BEST HIGH END CONDO ARCHITECTURAL
DESIGN (BANGKOK)

BEST HIGH END CONDO LANDSCAPE
ARCHITECTURAL DESIGN

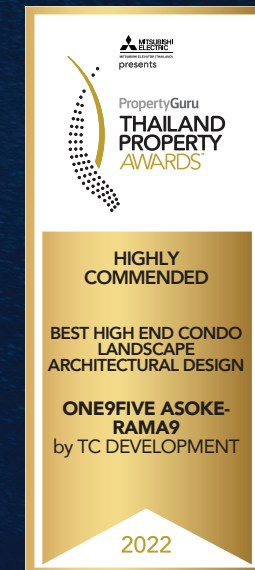
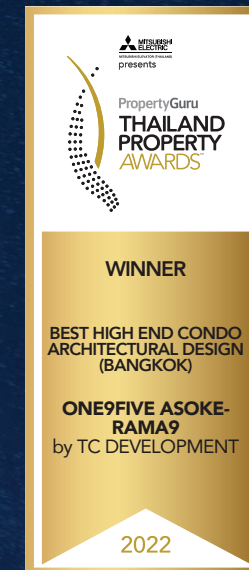
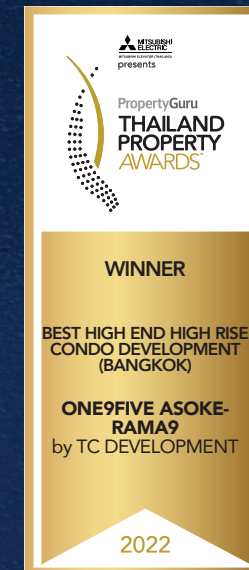



PICTURE OF THE ACTUAL PLACE

- Sky Residential Lounge
- Private Sky Meeting Room
- Private Sky Lounge
- Sky Bar



- Fitness Center
- Private Spa
- Steam Room
- Sauna Room
- Games Room
- Kid's Club
- Golf Simulator

PICTURE OF THE ACTUAL PLACE



- Pool Lounge
- Jacuzzi
- Residential Lounge
- Library Room
- Theatre Room
- Swimming Pool

PICTURE OF THE ACTUAL PLACE



PICTURE OF THE ACTUAL PLACE

- Grand Lobby
- Private Mezzanine Lounge
- Playground
- Co-Working Space
- EV Charge
- Community Kitchen

PROJECT DETAIL

PROJECT NAME One9Five Asoke – Rama 9

DEVELOPER TC Development

LOCATION Soi 5 Rama 9 Road, Huaykhwang District, Bangkok 10310

PROJECT TYPE 61 Floors High Rise Residential Condominium of 2 Building & Retail Shops

LAND AREA 11-1-6 Rai

TOWER A 954 Units

TOWER B 957 Units

UNITS / FLOOR Maximum 18 Units per floor (Corner Units Conceptual Design)

ELEVATOR 6 Passenger elevators per tower and 1 service elevator per tower

PARKING PROPORTION Approx. 50%

GROUND FLOOR
FUNCTION & ZONING



8th FLOOR
FUNCTION & ZONING



9th-28th FLOOR

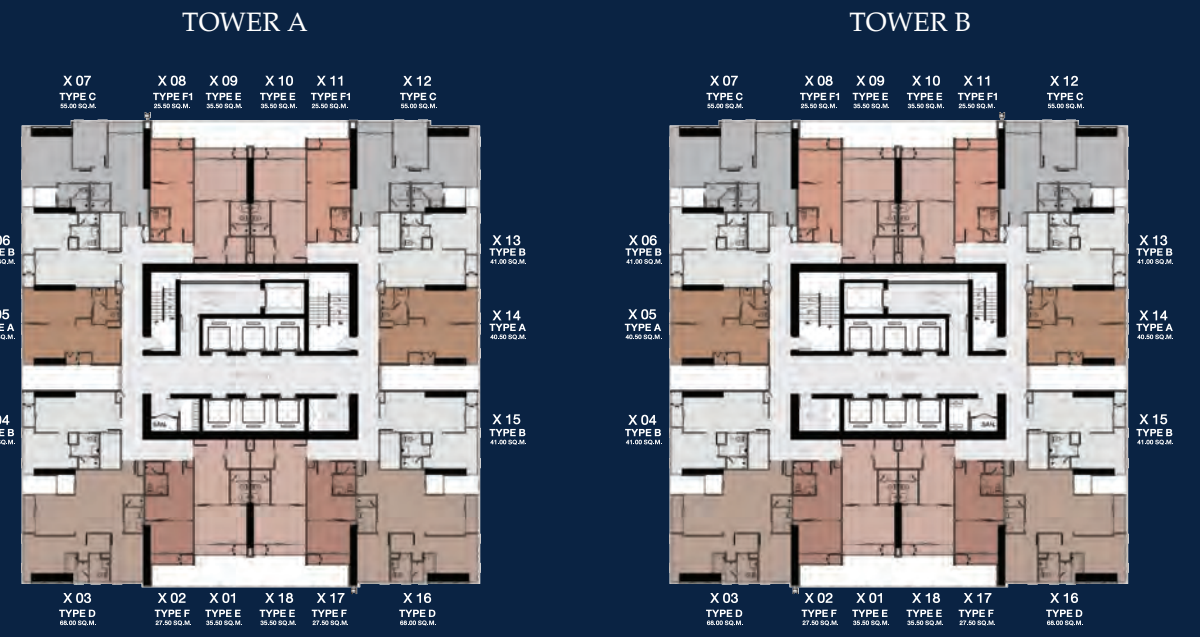

32nd-55th FLOOR



THE LOCATION OF EACH RESIDENCE DICTATES ITS UNIT LAYOUT AND PILLAR POSITIONS. THE DEVELOPER RESERVES THE RIGHT TO CHANGE WITHOUT PRIOR NOTICE. THE IDENTIFYING AREAS ARE APPROXIMATELY. CONTENTS AND IMAGES ARE FOR ADVERTISING PURPOSE ONLY. THE SHOW LAYOUT ARE SIMULATED UTILIZE FUNCTION ONLY.



PICTURE OF THE ACTUAL PLACE

UNIT PLAN



TYPICAL TYPE A
40.50 SQ.M.
(TYPE A1 : 36.00 SQ.M.)



MOCK UP ROOM IS FOR ADVERTISING PURPOSE ONLY



TYPICAL TYPE D
68.00 SQ.M.



MOCK UP ROOM IS FOR ADVERTISING PURPOSE ONLY



TYPICAL TYPE B
41.00 SQ.M.
(TYPE B1 : 36.50 SQ.M.)



MOCK UP ROOM IS FOR ADVERTISING PURPOSE ONLY



TYPICAL TYPE E
35.50 SQ.M.



MOCK UP ROOM IS FOR ADVERTISING PURPOSE ONLY



TYPICAL TYPE C
55.00 SQ.M.



MOCK UP ROOM IS FOR ADVERTISING PURPOSE ONLY



TYPICAL TYPE F
27.50 SQ.M.
(TYPE F1 : 25.50 SQ.M.)



MOCK UP ROOM IS FOR ADVERTISING PURPOSE ONLY

THE HIGHEST OF LIVING IN PRIME LOCATION

- ⊖ ONLY 250 M.* TO PHRA RAM 9 MRT STATION AND CENTRAL RAMA 9
- ⊖ ONE STATION TO AIRPORT RAIL LINK
- ⊖ EASY ACCESS TO BTS ASOK AND MRT ORANGE LINE
- ⊖ ONLY A FEW MINUTES BY CAR TO THE SI RAT EXPRESSWAY
- ⊖ NEAR PRARAM 9 HOSPITAL AND SHREWSBURY INTERNATIONAL SCHOOL

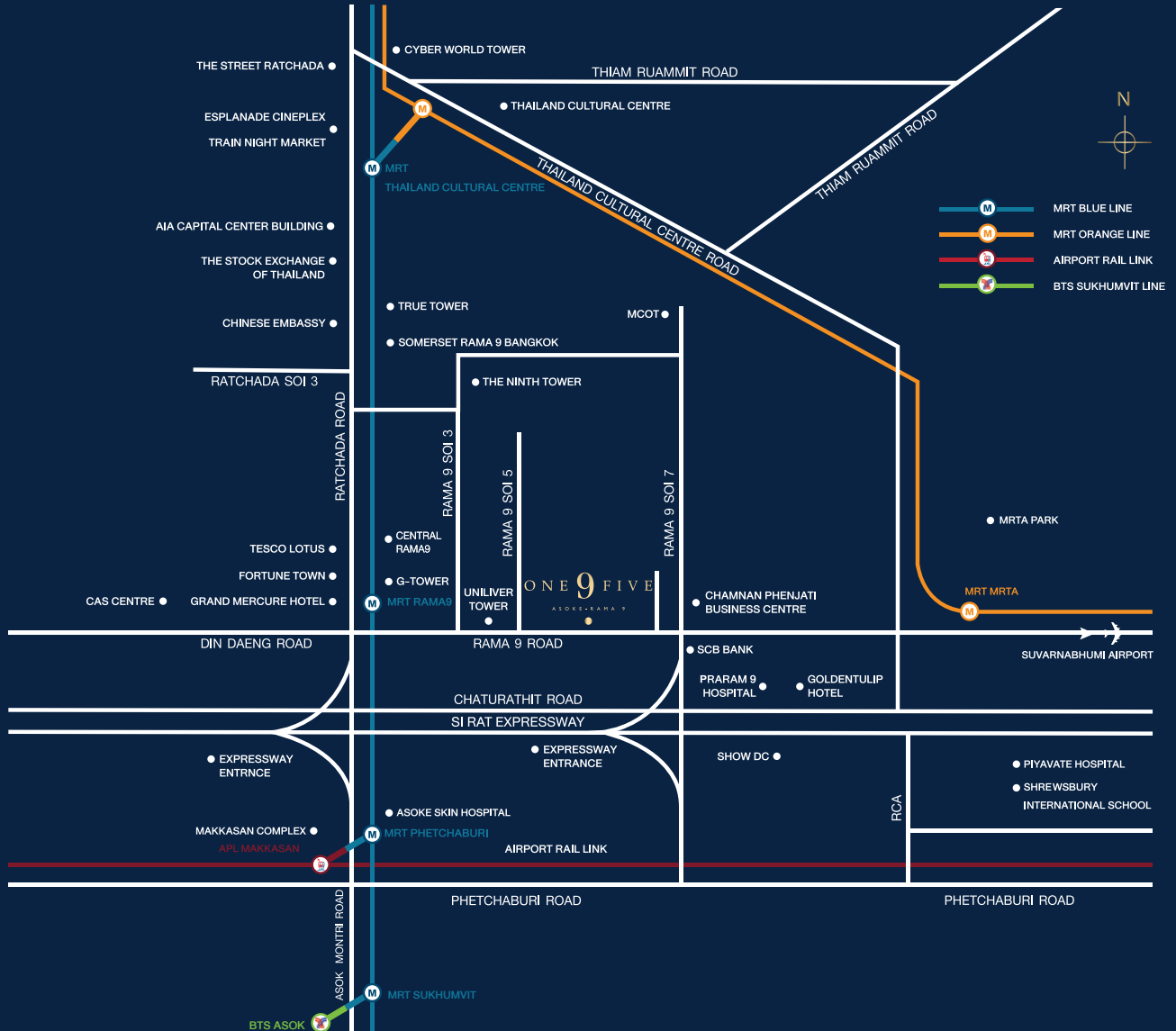

TC DEVELOPMENT
ONE9FIVE.COM

LINE: @TCDEVELOPMENT
02 245 0999

Project Developer: Tiancheng International Property (Thailand) Co., Ltd. Office Location 195/9 Rama 9 Huaykhwang District, Bangkok 10310 Thailand. Registered capital: 200,000,000 Thai baht. Authorizes Director: Mr. Ding Rongmao. The project name is "ONE9FIVE Asoke-Rama 9" and consists of 61 stories 2 buildings and 3 stories 1 building and 5 stories 1 building with 1,957 units. Site location 195/9 Rama 9 Huaykhwang District, Bangkok 10310 Thailand. Land title deed no. 5468. Project area 11-1-6 rai. Construction Start: estimated December 2017. Expected Completion: estimated April 2022. The Environmental Impact Assessment (EIA) is approved. To be registered under the condominium law after construction completed. The advertised picture of the actual place. The information in the disclaimer is subject to further changes and/or amendments by the developer without prior notice.